

PRODUCT DESCRIPTION:

The LB.6, LB.8 and LC.12 pumps are equipped with:

- Oil check valve
- Exhaust mist eliminator
- Gravity oil recovery valve (LB.6 – LB.8)
- Floating oil recovery valve (LC.12)
- Gas ballast continuously working
- Thermal protector (1~ only)

The limited dimensions and the low final pressure (Abs) attainable are the main features of this series. An effective damping and recovery system in-built in the tank prevents any oil vapors at the exhaust.

Moreover, a special sealing device prevents suck-back, should pump be stopped under vacuum.

The intake can also be adjusted by the user, thanks to a special fitting.

This series is suitable for evacuation of small closed vessels and (only LC.12) for a continuous operation within a pressure range from 400 to 2 mbar (Abs).

MAIN APPLICATION FIELDS:

Vacuum technology is essential in food packaging: in filling and sealing machines, in food packing and food processing, and in the production of PET containers.

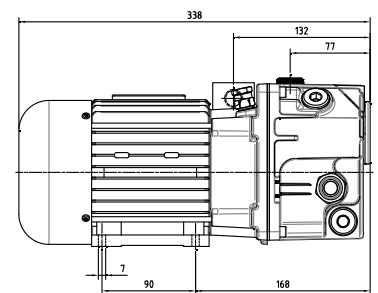
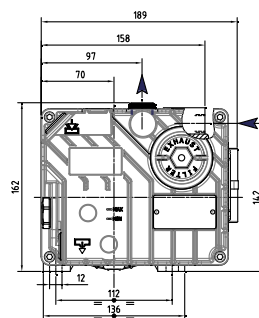
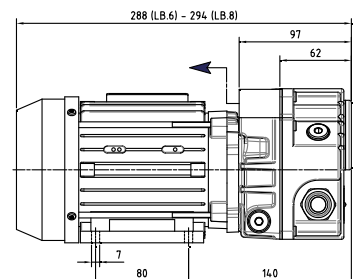
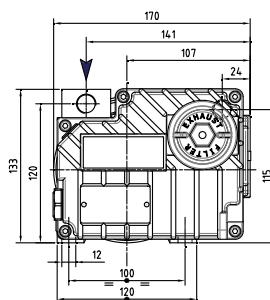

Main accessories	LB.6	LB.8	LC.12
Minor spare parts kit	K9601058	K9601055	K9601064
Major spare parts kit	K9601058/1	K9601055/1	K9601064/1
Shock mount	4 x 1503005		
Inlet filter	9001004/0		9001010
Stepped hose fitting	2103007 (Ø12)		2103010 (Ø12)
Vacuum gauge	9009004		9009009

Subject to change without prior notice

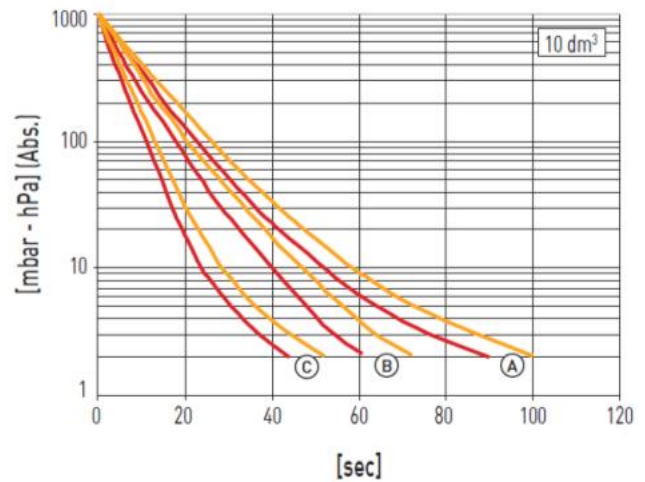
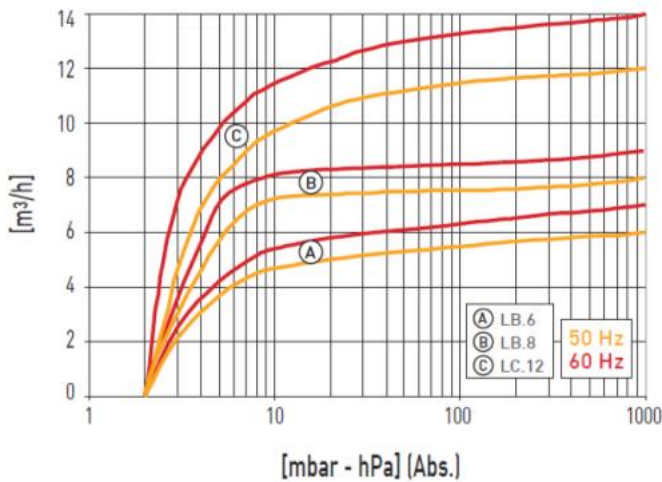

NOTE: Graph shows inlet pressure at a temperature of 20°C (tolerance ±10%)

Subject to change without prior notice

	LB.6		LB.8		LC.12		
	50Hz	60Hz	50Hz	60Hz	50Hz	60Hz	
Catalogue code	9601058		9601055		9601064		
Nominal capacity	m³/h	6	7	8	9	12	14
Total final pressure (Abs)	mbar - hPa	2					
Max inlet pressure for water vapour	mbar - hPa	---				35	
Max water vapour pumping rate	kg/h	---				0,30	
Motor power	(1~/3~) KW	0,25/0,25	0,30/0,30	0,25/0,25	0,30/0,30	0,45/0,37	0,55/0,45
Nominal r.p.m.	n/min	2800	3300	2800	3300	2800	3300
Noise level (UNI EN ISO 2151 - K 3dB)	dB(A)	58	60	58	60	62	64
Weight	(1~/3~) kg [N]	10 [98,1] / 9 [88,3]				14 [137,3] / 12,5 [122,6]	
Type of oil	cod. DVP	BV32 (SW40)					
Oil quantity	dm³	0,20				0,30 ÷ 0,40	
Pump intake / outlet		3/8"G / 1/4"G				1/2"G / 1/2"G *	
Continuous-duty working range (Abs)	mbar - hPa	---				400 ÷ 2	
Operating temperature @ 20°C	°C	65÷70	70 ÷ 75	70 ÷ 75	75 ÷ 80	60 ÷ 65	65 ÷ 70
Required room temp. for place of installation	°C	12 ÷ 40					
Ambient temperature for storage/transport	°C	-20 ÷ 50					
Max humidity / altitude		80% / 1000m s.l.m. **					

(*) When the exhaust plug is removed.

(**) Please contact us if environmental conditions are different from those prescribed.